

REVISIONS				
ZONE	REV	DESCRIPTION	DATE	APPROVED
			08/22/13	

Note: Tab thick is 0.2mm

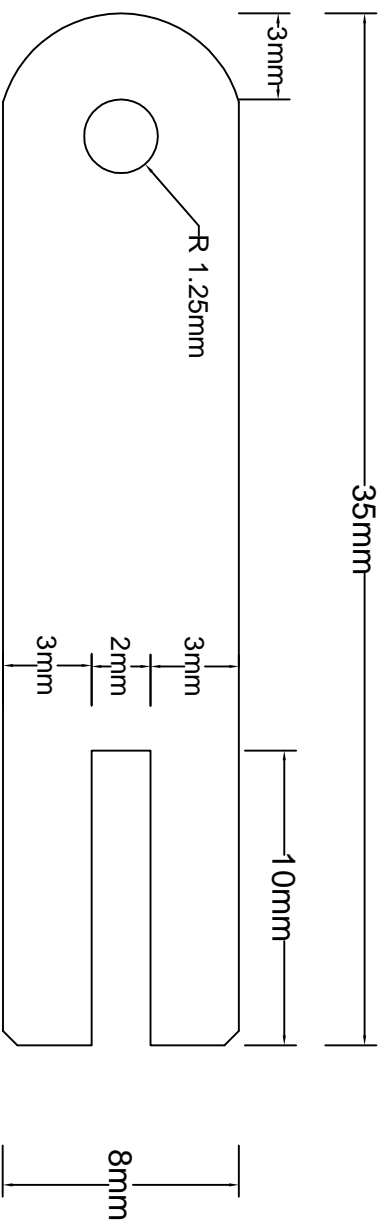

TB-DSB

CELL:				
TYPE	E	Ah	QTY	
AA PORTABLE POWER				
825 SOUTH 19TH STREET #A RICHMOND CA,94804			Part NO.	
SIZE DWG NO.			TB-DSB	
SCALE None			SHEET 1 of 1	
NOTE:				
REV				