

REVISIONS				
ZONE	REV	DESCRIPTION	DATE	APPROVED
			08/22/13	

Note: Tab thick is 0.25mm

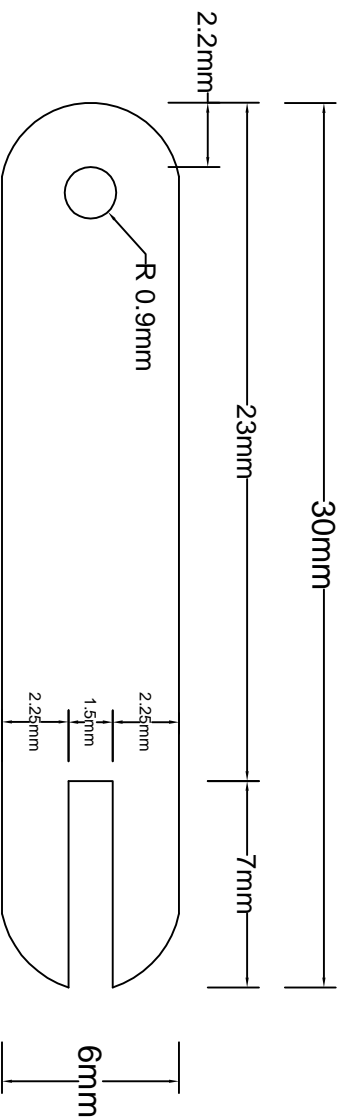

TB-CS

CELL:				
TYPE	E	Ah	QTY	
AA PORTABLE POWER				
825 SOUTH 19TH STREET #A RICHMOND CA,94804			Part NO.	
SCALE	None	SIZE	DWR NO.	
NOTE:				
TB-CS				REV
SHEET	1 of 1			