

型号(Type) : MH-2/3A1600B

单颗电池规格 Specifications of single cell

标称电压 Nominal voltage		1.2V	
容量 Capacity	1.0C 放电 Discharge		
	最小 Minimum	48min	
	典型 Typical	50min	
尺寸 Dimensions	直径 Diameter	mm 17.0 ^{-0.7}	
	高 Height	28.5 ^{-1.0}	
大约重量 Weight(Approximately)		克 gram 22.5	
内阻 Internal Impedance At 1000 Hz		12mΩ(Max) (充电后 After Charge)	
充电 Charge	标准 Standard	160mA(0.1C)×15hrs	
	快速 Rapid	1600mA(1.0C)×1.1hrs	
环境温度 Ambient temperature	充电 Charge	标准 standard	0°C to 40°C
		快速 Rapid	0°C to 40°C
	放电 Discharge		-20°C to 50°C
	贮藏 Storage		-20°C to 30°C

单颗电池尺寸包括 PVC (Dimensions with tube)

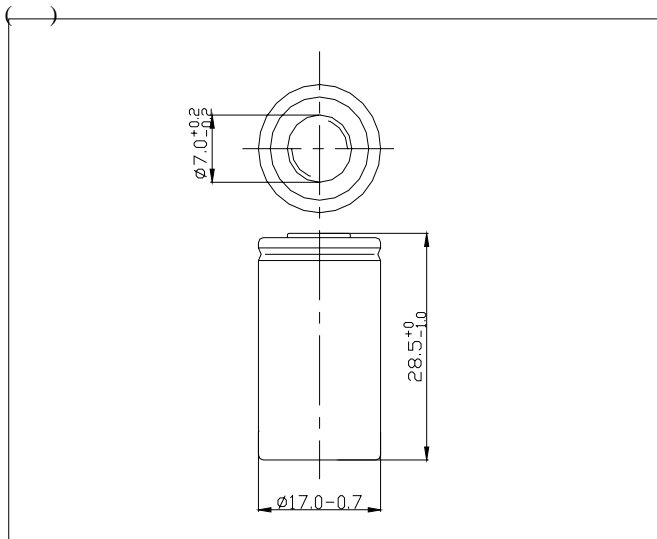

备注 Note:

1. 标称容量是指 20°C 时 0.2C 放电容量
Nominal capacity, rated at 0.2C 20°C.
2. 容量只作为参考
Average capacity, for reference only.
3. 重量和内阻也作为参考
Weight and internal impedance are For reference.
4. 寿命测试依照 IEC 标准
Standard according as IEC of test cycle life.

典型特征 Typical characteristics

标准充电特征 Standard charge

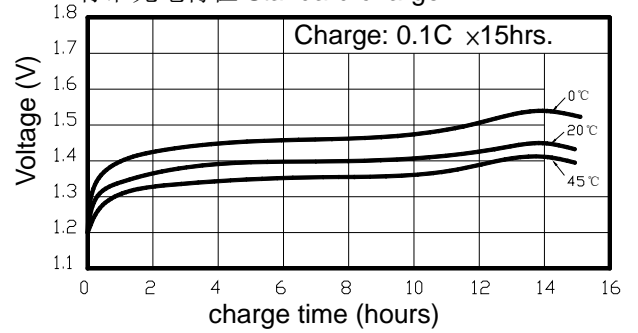

快速充电特征 Rapid charge

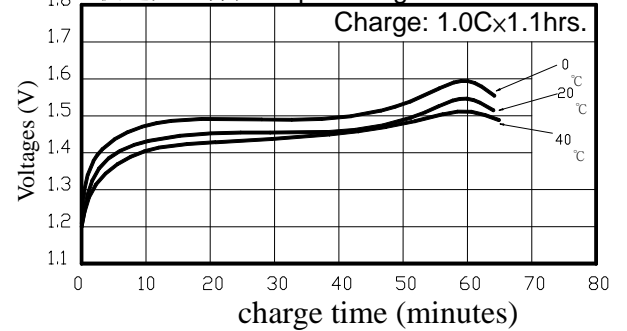

放电特征 Discharge characteristics

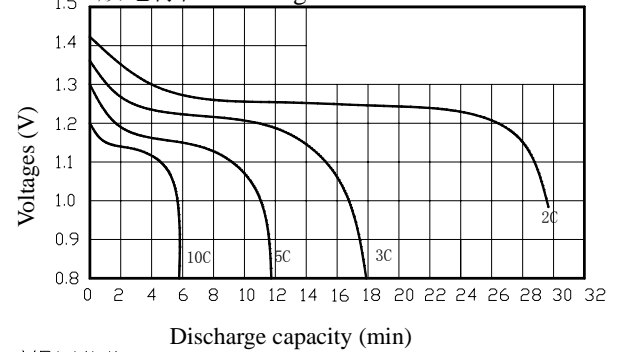

MPV (<V>)

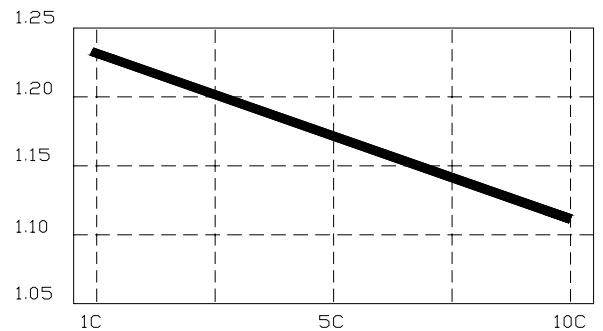

Ni-MH 圆柱型电池在不同的温度荷电保持曲线图
Charge retention curves of Ni-MH cylindrical cell At various storage temperature

