

Specification & Instruction of Smart Charger CH-UN8412

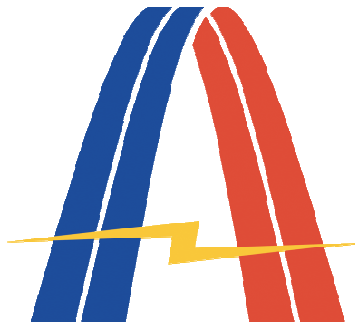

www.BatterySpace.com

AA Portable Power Corp

Specification:

<p>Feature</p>	<ul style="list-style-type: none"> • Designed for 8.4V - 12V NiNH/NiCd battery pack with capacity which is 700mAh • Input Power: 100V - 240V AC (universal AC male adapter) • Output: 16VDC, 700mA (5.5 x 2.1mm male plug & Clips)
<p>Function</p>	<ul style="list-style-type: none"> • Automatic voltage detection with LED indicator (red/green) during charging process Connector to AC Power: Green Charging: Red Fully charged: Green • Automatic cut-off charging function by IC Stop charging when $-\Delta V$ is detected by IC
<p>Safety Protection</p>	<ul style="list-style-type: none"> • The protection is built in the charger for short circuit, and reverse polarity
<p>Dimension</p>	<p>L 3.1" X W 2.0" X H 1.2"</p>
<p>Weight</p>	<p>6.9oz (196g)</p>

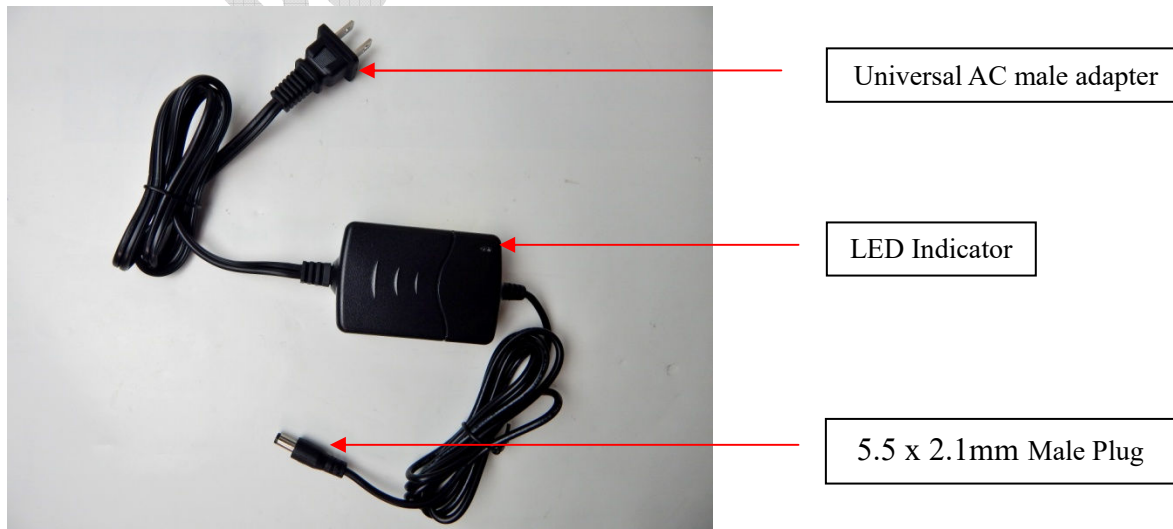



Instruction:

Please carefully read the following instruction before you start to use this charger.

Caution:

- This charger is for Indoor use only
- The charger shall be placed on a fixed horizontal surface when the charger is operated
- Avoid storing or operating the charger in highly humid place or any place with inflammable good
- Do not cover the charger when the charger is operated
The ambient temperature shall not excess 40 °C
- Do not charge the battery on the list below
Voltage < 8.4V, or Voltage > 12V
Capacity < 700mAh
- Battery must be made by high drain current cell
- Do not disassembly the charger any time
- AA Portable Power is not responsible for any damage caused by any misuseage

Operation Steps:

1. Connect the transfer cable (5.5 x 2.1mm male adapter - alligator clip) to the output of the charger (5.5 x 2.1mm female adapter)
2. Connect the battery to transfer cable with correct polarity
(Red cable connects to positive, Black cable connects to negative)
3. Plug the input of the charger (universal AC male adapter) into the power resource.
4. When the battery does not connect to battery, the LED indicator turns to Green. When it is in charging process, the LED indicator turns Red. When the battery is fully charged, the LED indicator will be Green
5. The charging time is variable depends on the battery.

Special Notes:

1. Must connect the battery first, then connect to AC power.
2. If the battery is old, the charger may not be able recognize the battery, please unplug and plug the power cable again.