

# DC Motor: High Torque Mini 24V DC Gear Motor, 300 rpm for Hobby / Robots

(Part# MT-300)

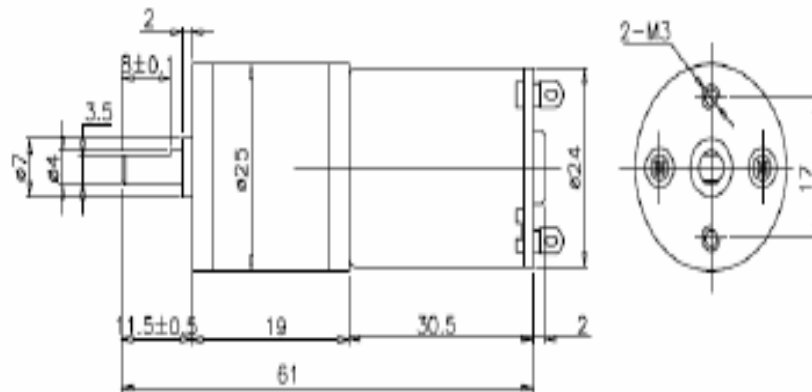

Motor Spec (Model# 25GA370D12, i = 20.3)

1. Voltage: 24.0VDC
2. Output Speed: 300 RPM
3. No-Load output current: 70 mA
4. Rotation Output: CW / CCW
5. Noise: No Gear Noise
6. Stall output: : Slip Gear, Broken Gear is no allowed
7. Output shaft of the axial clearance: =< 0.1 ~ 0.3mm, Horizontal clearance requirement =< 0.05
8. Stall Current: 2.0A

Electrical Spec

1. No-Load Speed: 6000 RPM
2. No-Load Current: =< 50mA
3. Rotation: CW
4. Motor#: 370